

# INSTALLATION INSTRUCTIONS FOR THE INSTALLATION OF TEGOLA CANADESE COMPACT TILES ON CURVED ROOFS

Apply a 4 mm polyester torch on membrane over the whole surface of the roof ( drwg. 1) and overlap the membrane of 10%.

As soon as finished with this waterproofing divide the roof in sections of approx. 4 meters (14 foot) (drwg.1) and apply ( solution A) a list of 4 x 5 cm (1 1/2"x 2" ) fixing it each 60 cm (2') between the sections or apply a flashing (Solution B) as on drwg. 2 and 3. As on drwg. 4 you have to waterproof again using pieces of the torch on membrane for Solution A and B. As to the installation instructions you have to mark the roof ( drwg. 5)

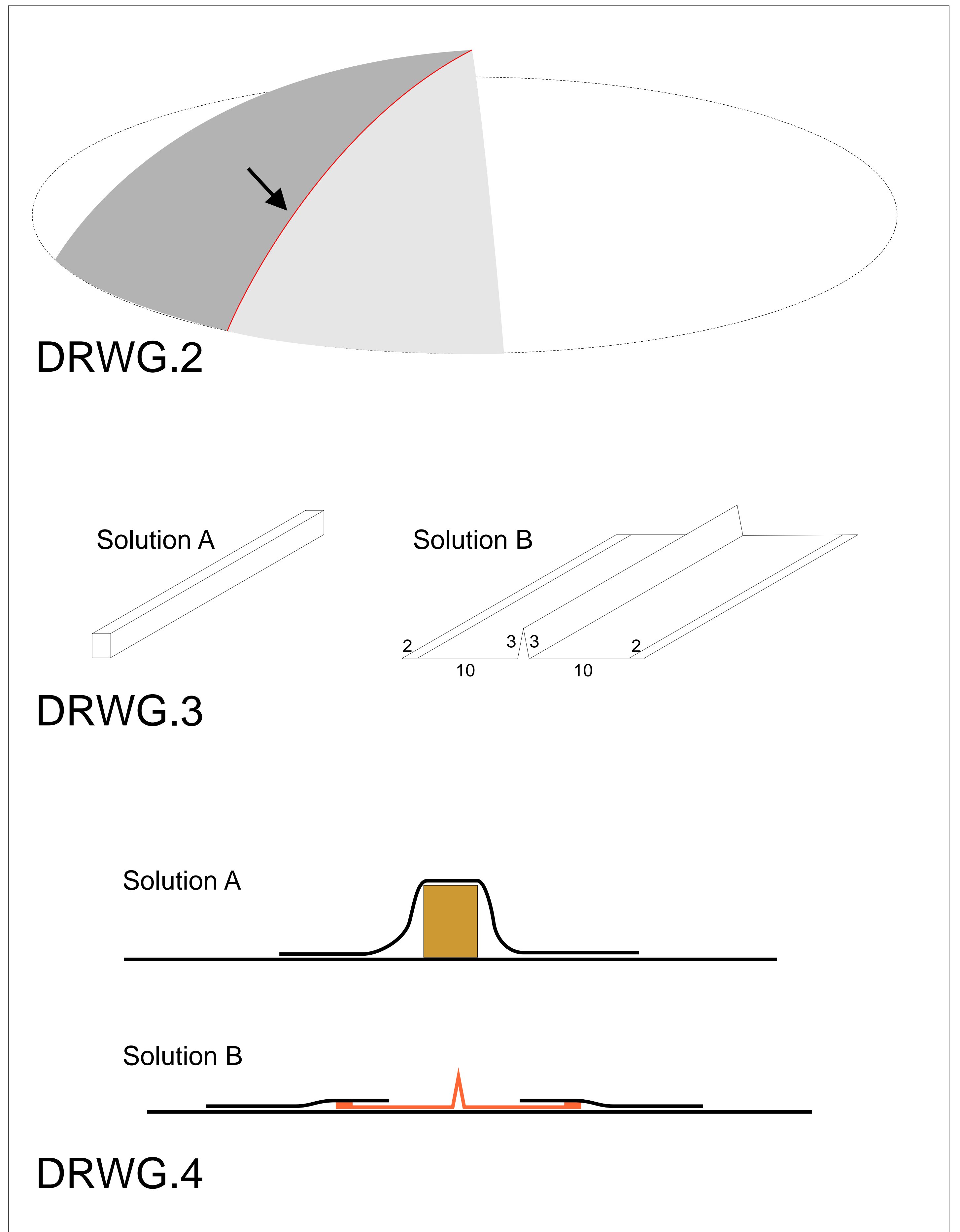
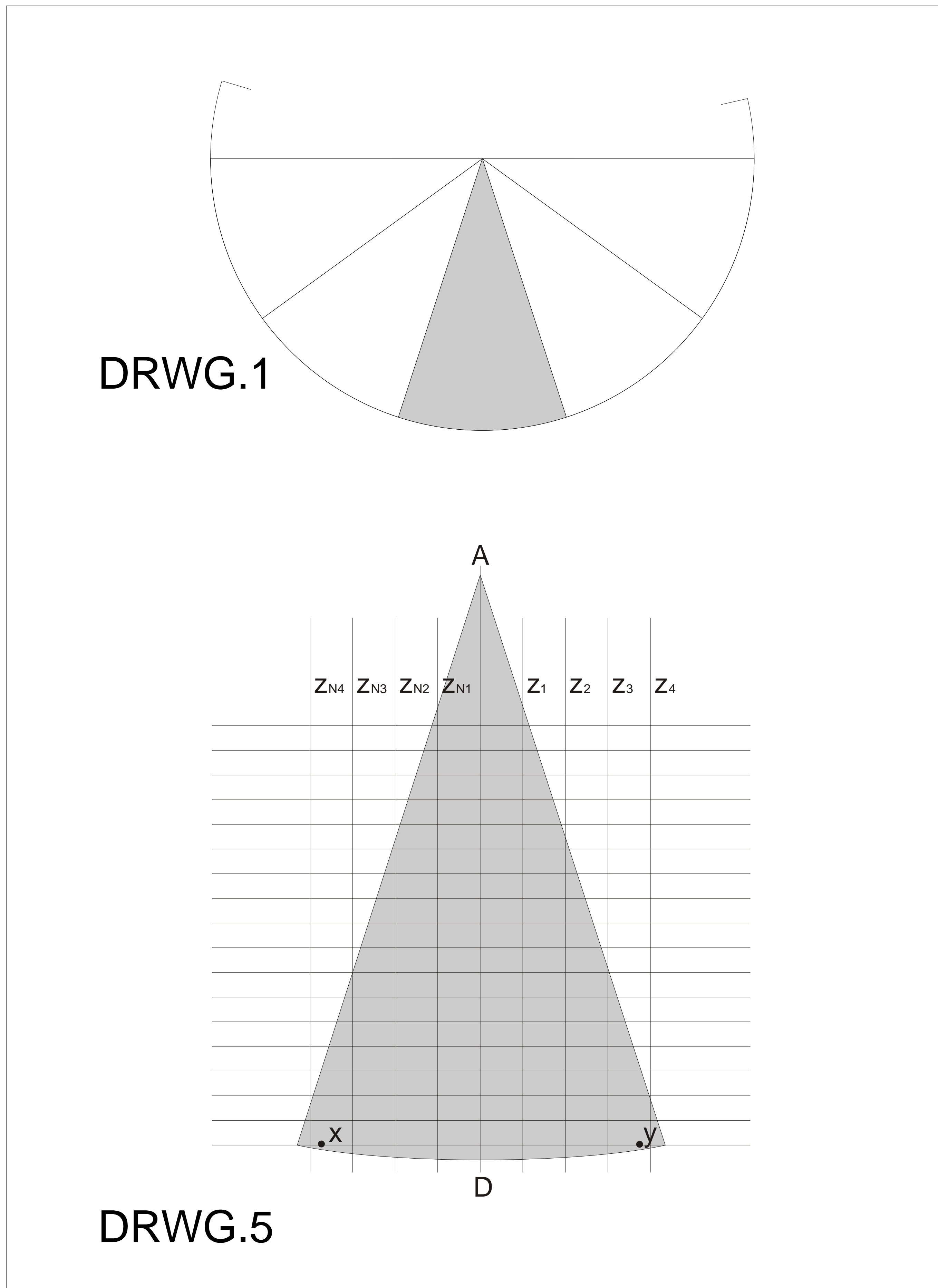

Proceed with the installation of the tiles

How to bend the copper of the tiles. This is to be done very carefully.

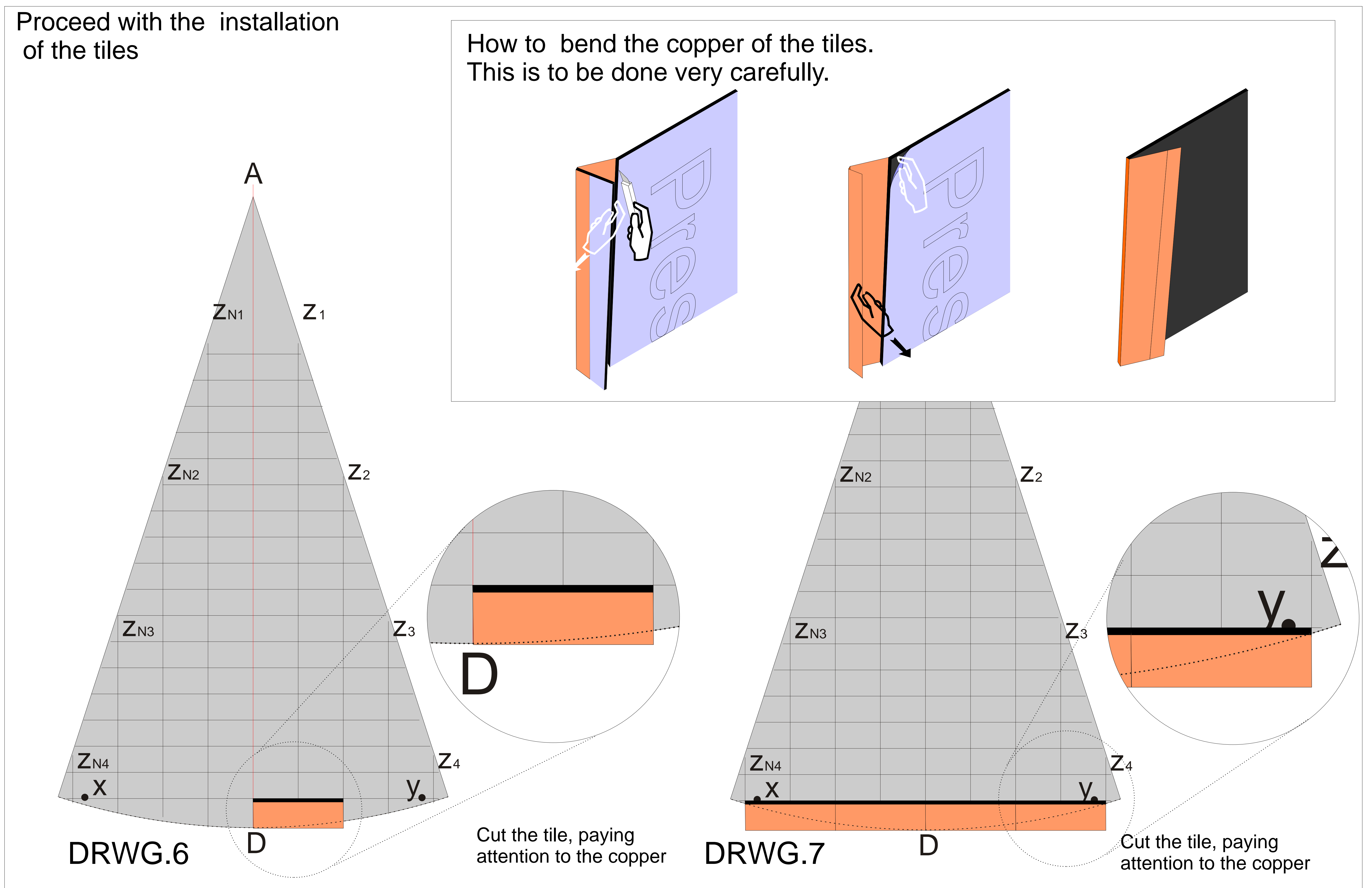
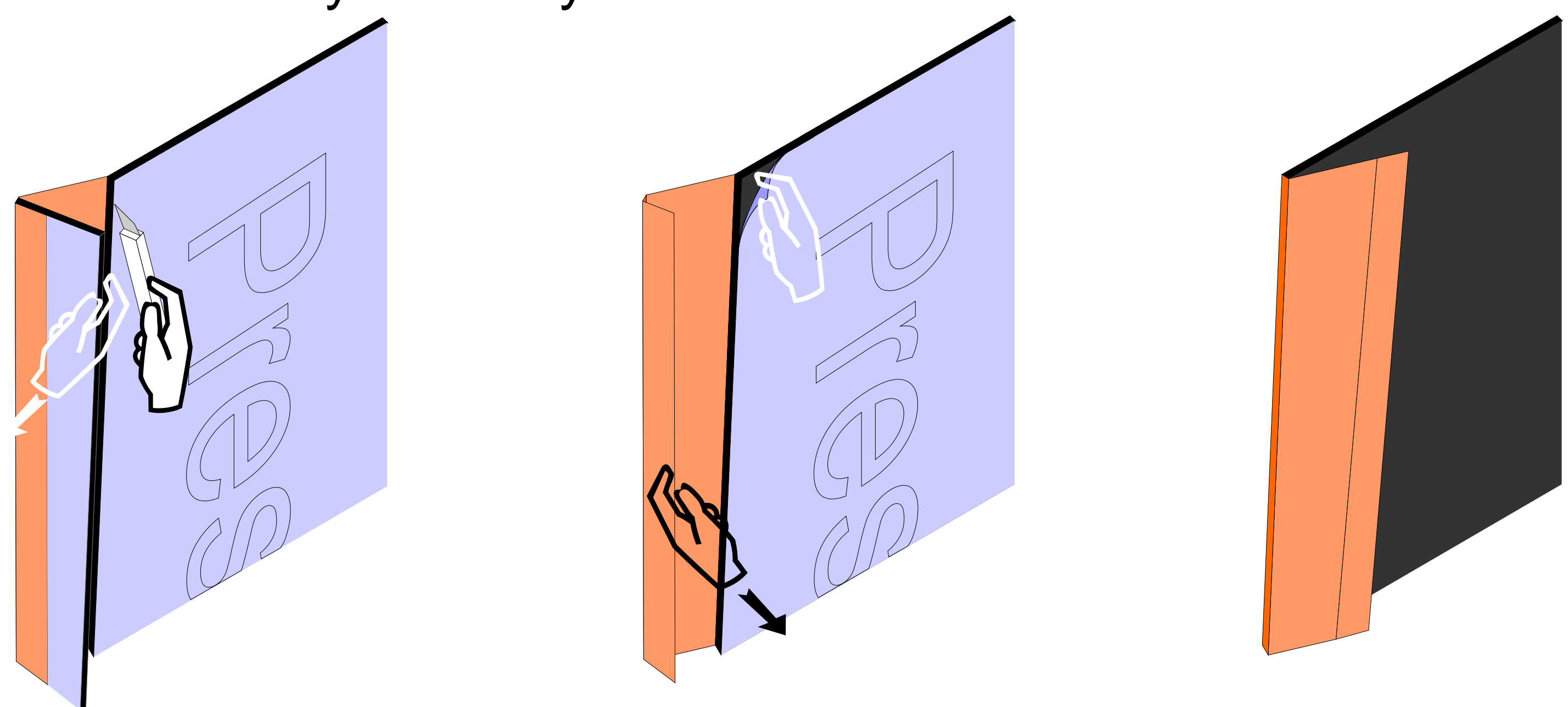

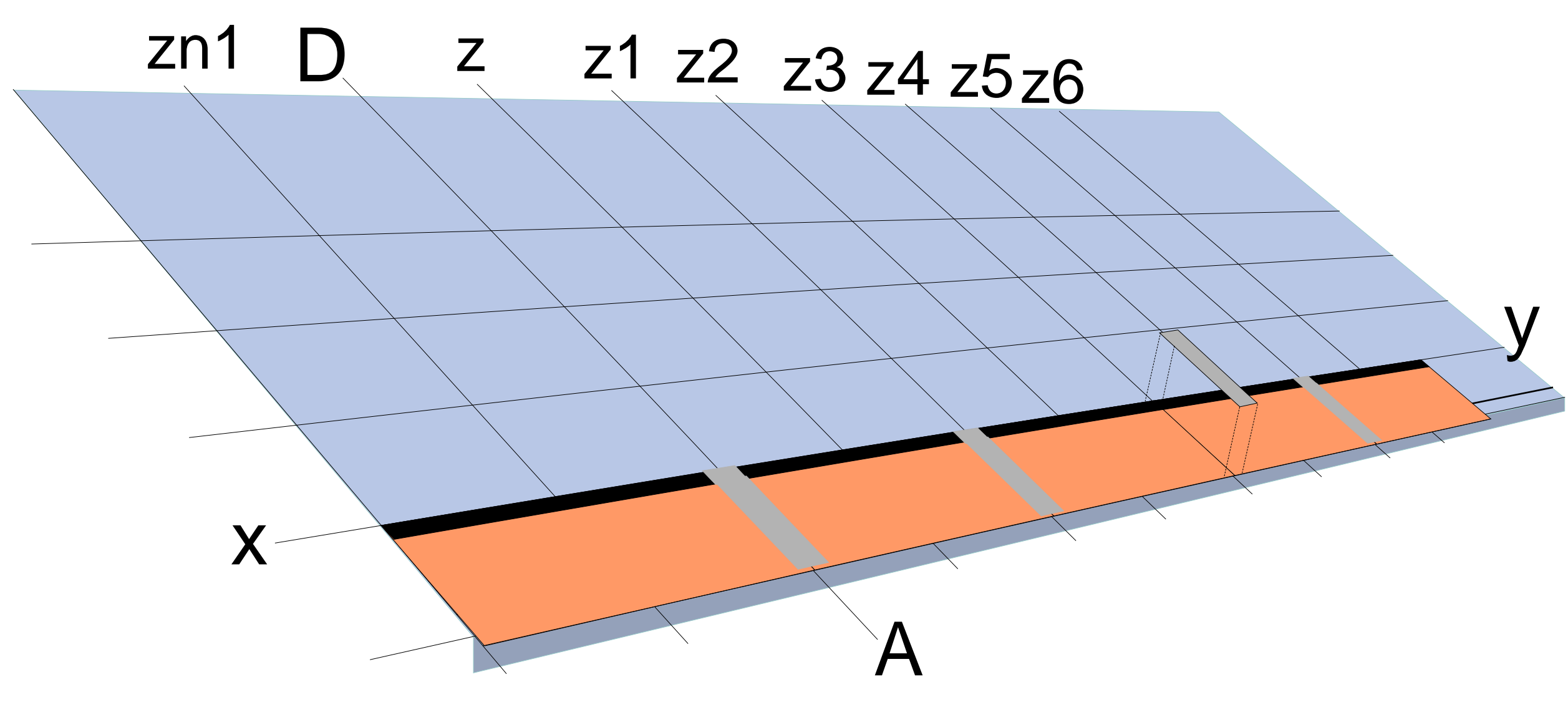

DRWG.8

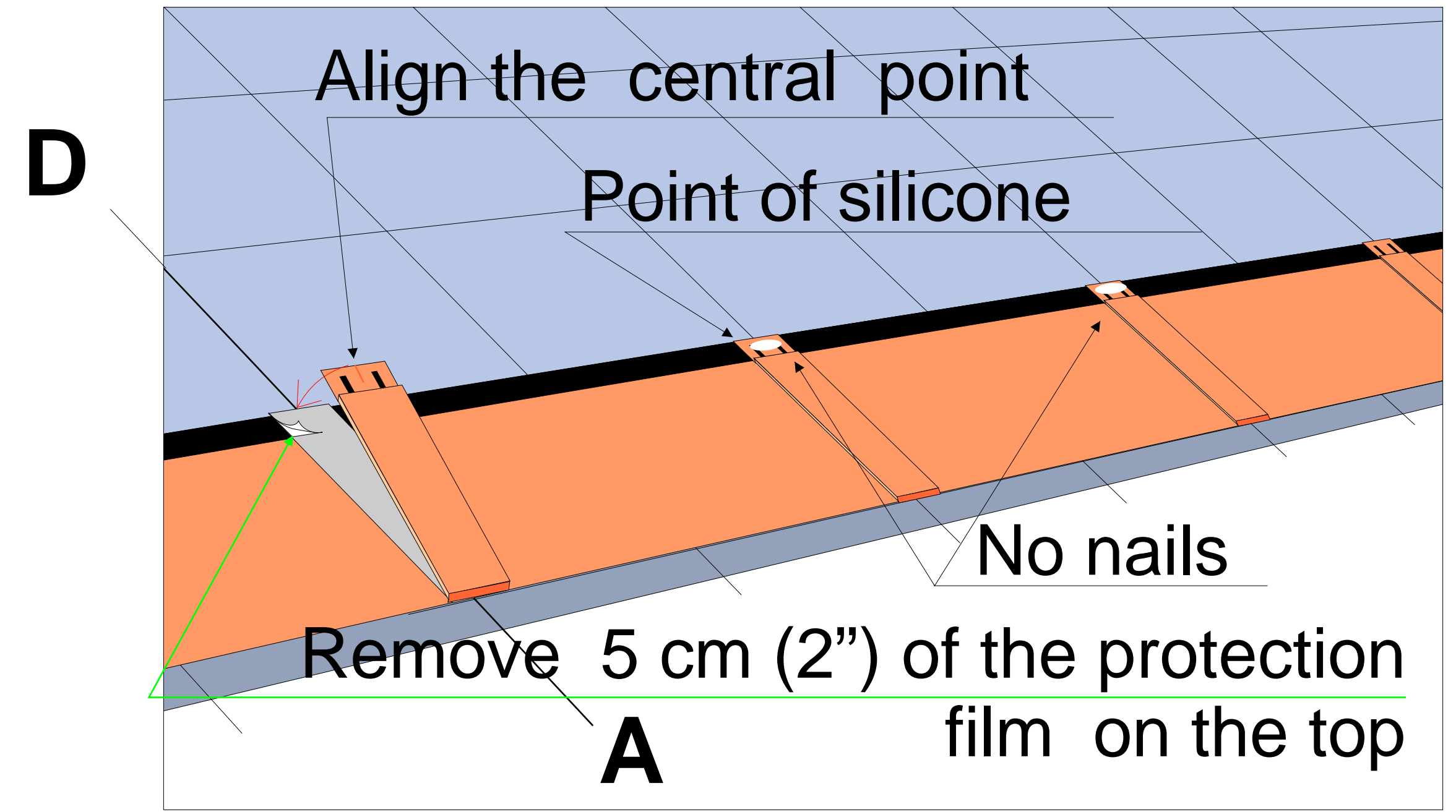

DRWG.9

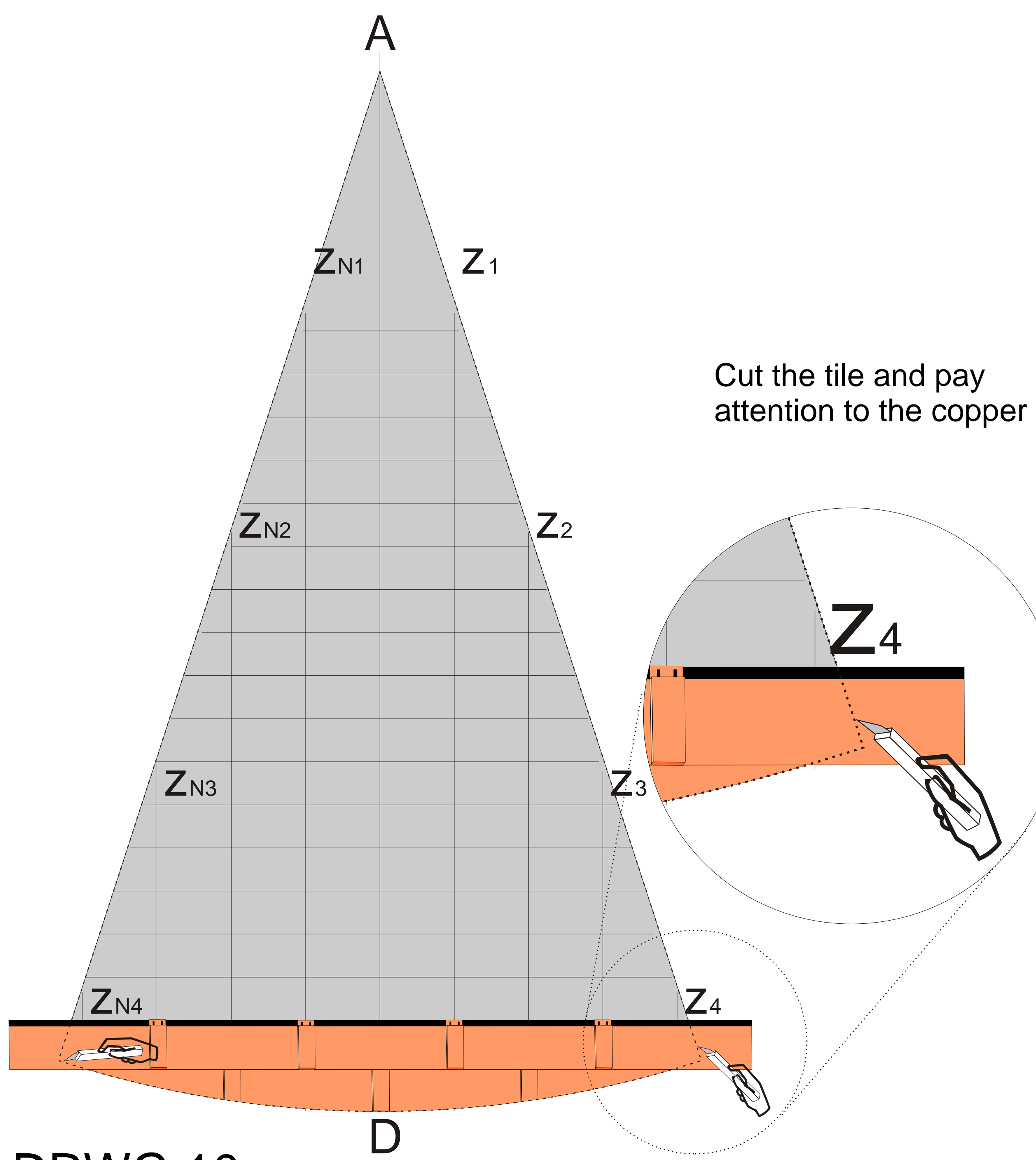

DRWG.10

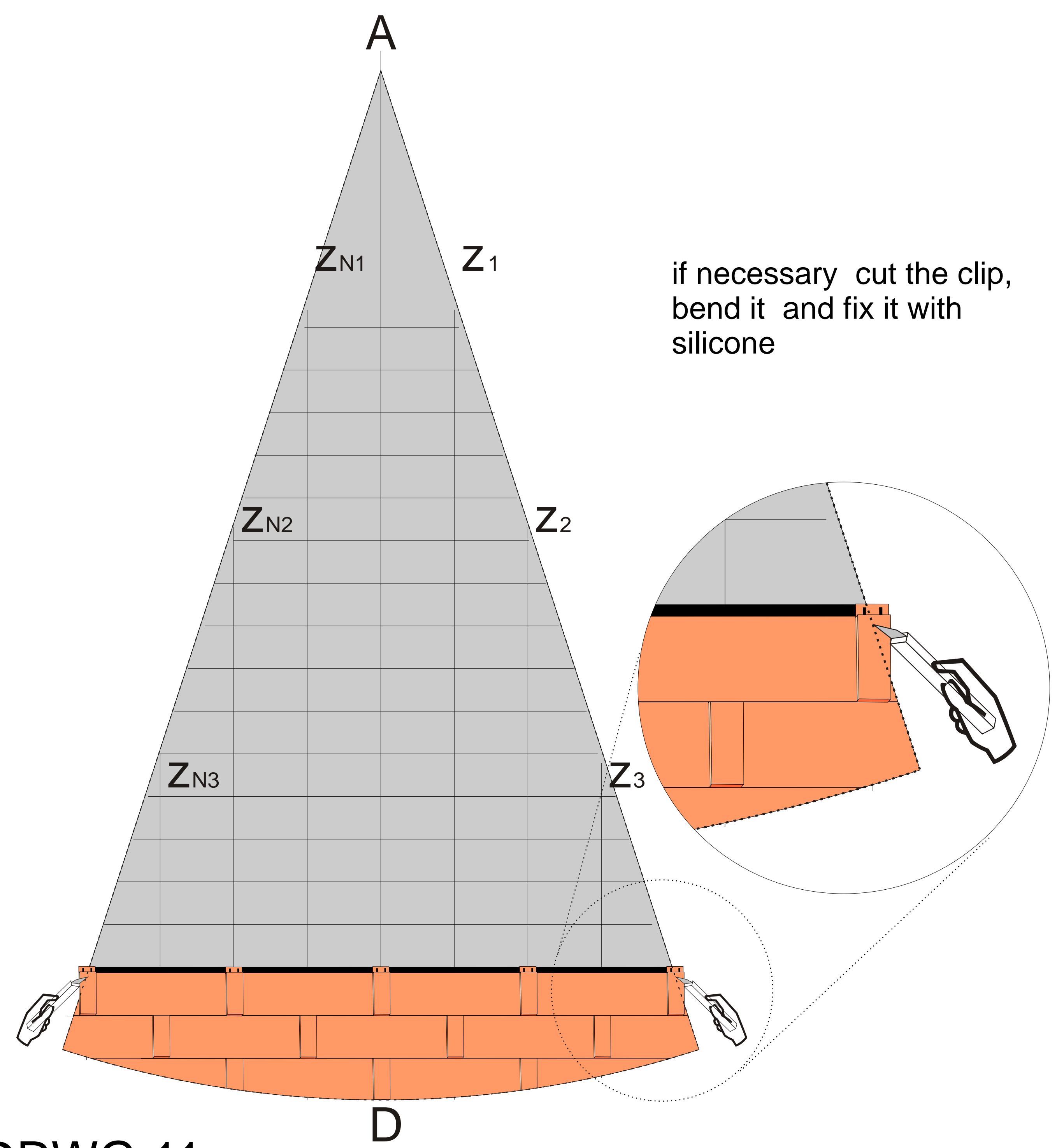

DRWG.11

Complete the shingles' installation.

- Solution A: install a flashing of protection for the list as on drwg.12
- Solution B: waterproof the joint with silicone drwg.13

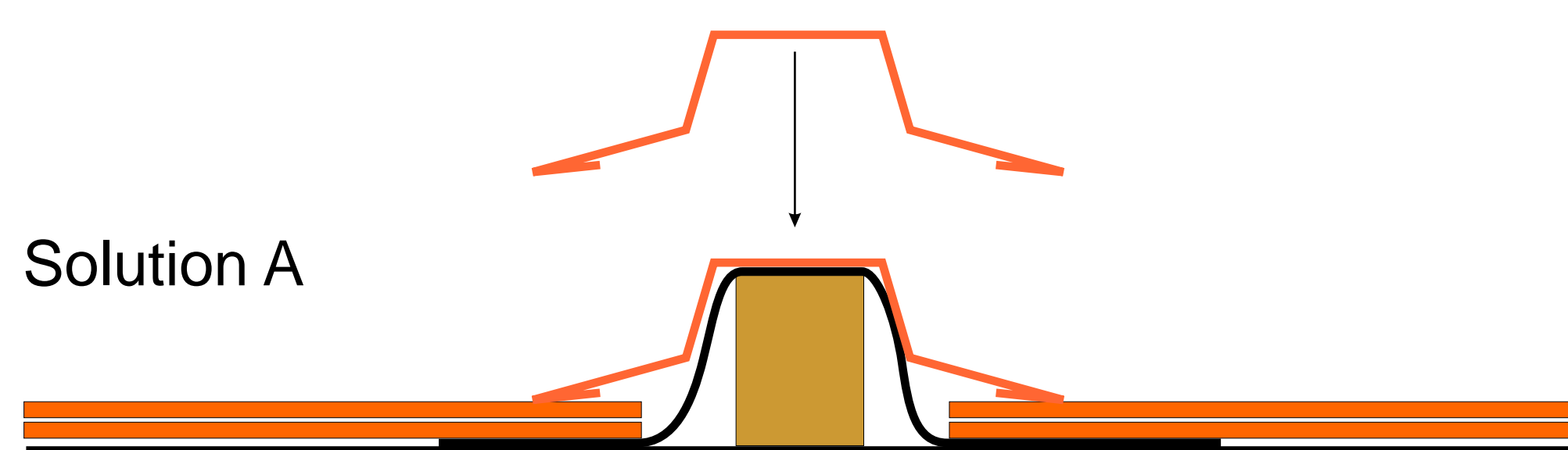

DRWG.12

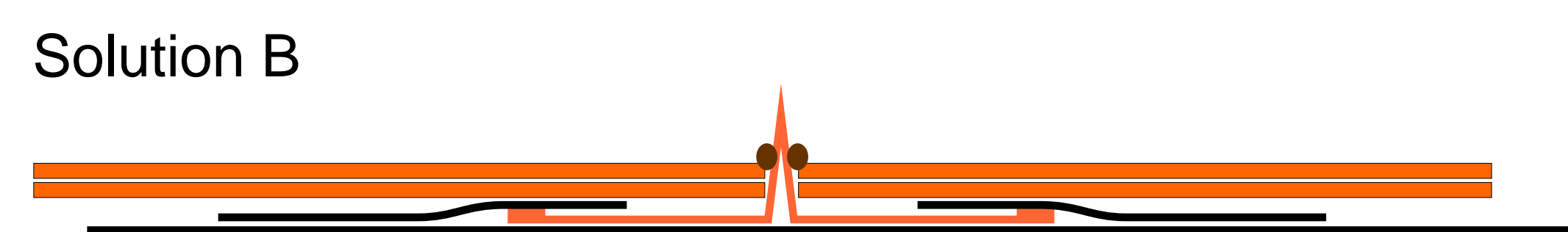

DRWG.13